

Blind Rivet Set

Art.no 40-8706

Please read the entire instruction manual before using the product and then save it for future reference. We reserve the right for any errors in text or images and any necessary changes made to technical data. If you have any questions regarding technical problems please contact our Customer Services.

Operating instructions

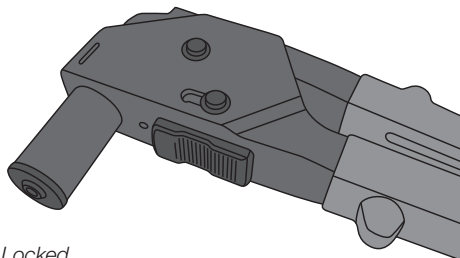

Locked

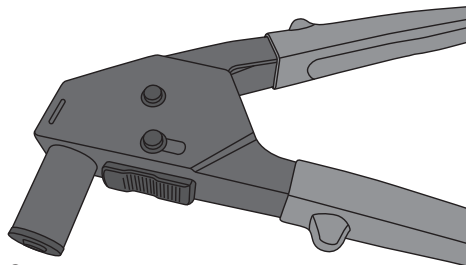

Open

1. Insert the blind rivet into the rivet tool and then into the hole.

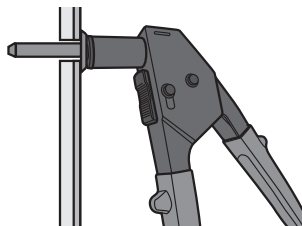

2. Squeeze the handles of the rivet tool together until the rivet is locked tight.

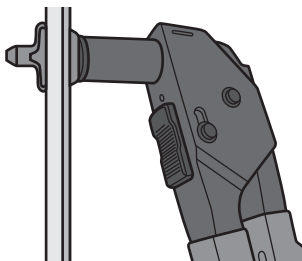

3. Break off the mandrel of the rivet or cut it off using side cutters.

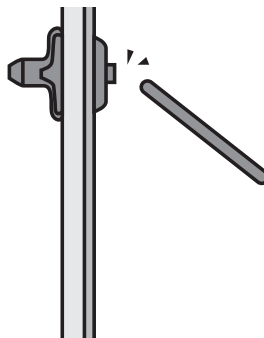

Typical application

Repairing a loose car wheel arch liner

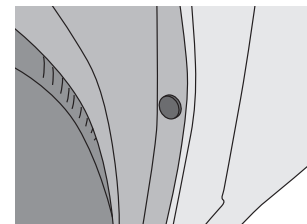
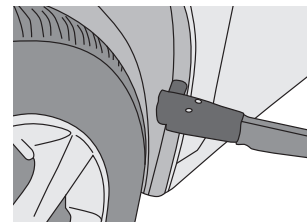

Disposal

This product should be disposed of in accordance with local regulations. If you are unsure how to proceed, contact your local authority.

Specifications

Included blind rivets:
10 pcs 5 × 15.8 mm
10 pcs 5 × 17.2 mm
10 pcs 6.6 × 17.2 mm
10 pcs 6.3 × 25.2 mm

Blindnitsats

Art.nr 40-8706

Läs igenom hela bruksanvisningen före användning och spara den sedan för framtida bruk.

Vi reserverar oss för ev. text- och bildfel samt ändringar av tekniska data. Vid tekniska problem eller andra frågor, kontakta vår kundtjänst.

Användning

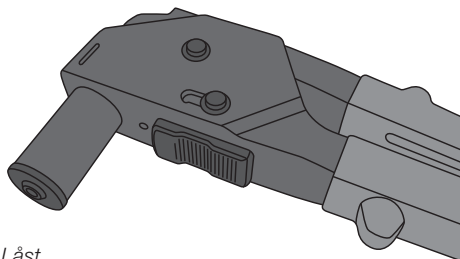

Låst

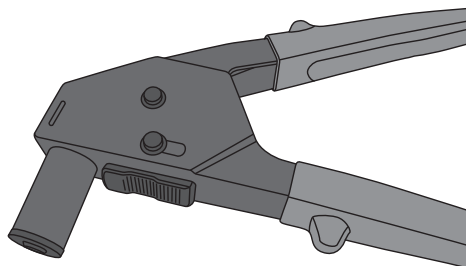

Öppen

1. Sätt blindniten i tången och sedan i hålet.

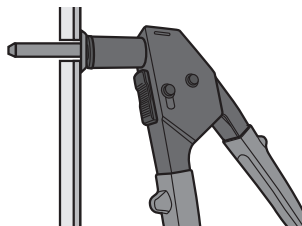

2. Dra ihop tångens handtag tills blindniten låser fast.

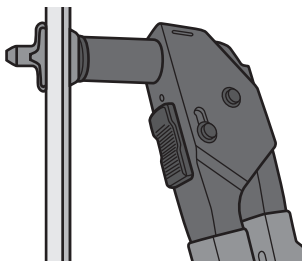

3. Bryt av nitens skaft eller klipp av den med en avbitare.

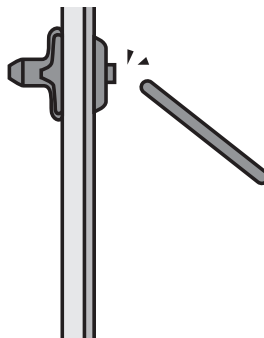

Exempel på användningsområde

Reparation av lös innerskärm på bil

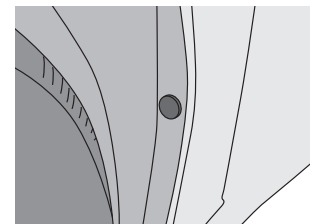
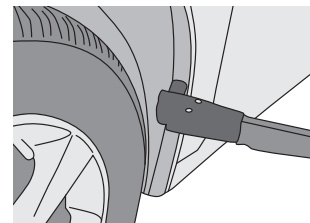

Avfallshantering

När du ska göra dig av med produkten ska detta ske enligt lokala föreskrifter. Är du osäker på hur du ska gå tillväga, kontakta din kommun.

Specifikationer

Medföljande blindnitar:

- 10 st. 5 × 15,8 mm
- 10 st. 5 × 17,2 mm
- 10 st. 6,6 × 17,2 mm
- 10 st. 6,3 × 25,2 mm

Blindnaglesett

Art.nr. 40-8706

Les gjennom hele bruksanvisningen før bruk, og ta vare på den for fremtiden. Vi tar forbehold om eventuelle tekst- og bildefeil samt endringer i tekniske data. Hvis det skulle oppstå tekniske problemer, eller hvis du har spørsmål, kan du ta kontakt med kundeservice.

Bruk

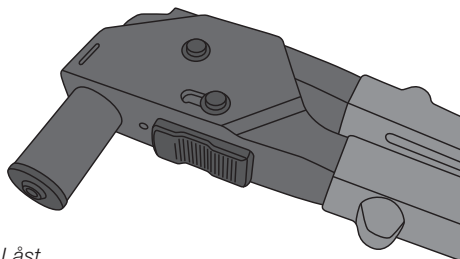

Låst

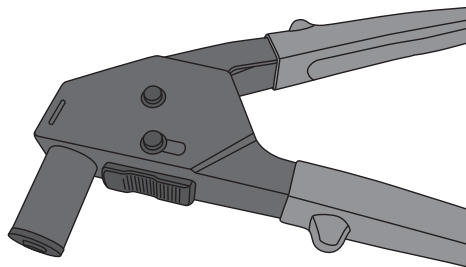

Åpen

1. Sett blindnaglen i tangen og deretter i hullet.

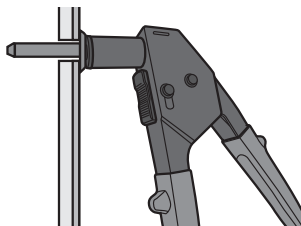

2. Klem sammen tangens håndtak til blindnaglen låses fast.

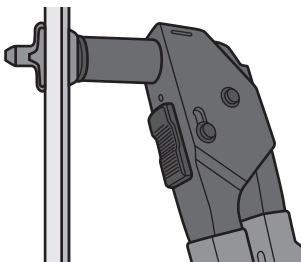

3. Bryt av skaftet på naglen, eller klipp det av med en avbitertang.

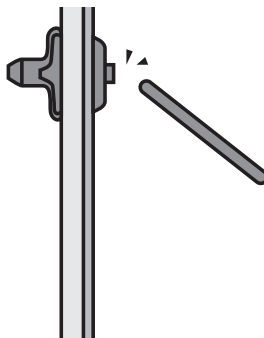

Eksempel på bruksområde

Reparasjon av løs innerskjermer på bil

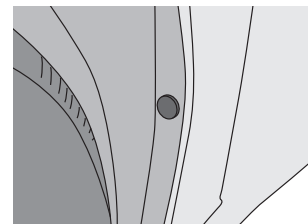
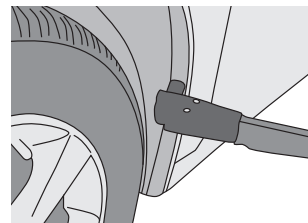

Avfallshåndtering

Når du skal kassere produktet, skal dette skje i henhold til gjeldene forskrifter. Hvis du ikke vet hvordan du skal gjøre dette, kan du ta kontakt med kommunen.

Spesifikasjoner

Medfølgende blindnagler:

10 stk. 5 × 15,8 mm.

10 stk. 5 × 17,2 mm.

10 stk. 6,6 × 17,2 mm.

10 stk. 6,3 × 25,2 mm.

Vetoniittisarja

Tuotenumero 40-8706

Lue käyttöohjeet ennen tuotteen käyttöönottoa ja säilytä ne tulevaa tarvetta varten. Pidätämme oikeuden teknisten tietojen muutoksiin. Emme vastaa mahdollisista teksti- tai kuvavirheistä. Jos tuotteeseen tulee teknisiä ongelmia, ota yhteys myymälään tai asiakaspalveluun.

Käyttö

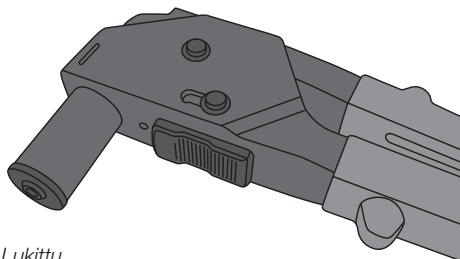

Lukittu

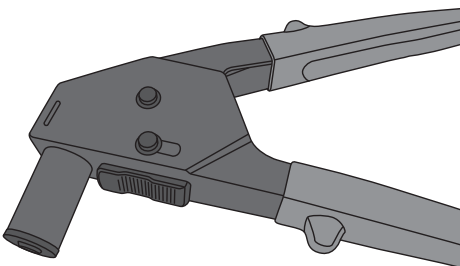

Auki

1. Aseta vetoniitti pihteihin ja sen jälkeen reikään.

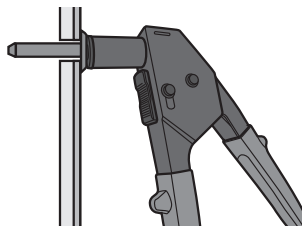

2. Purista pihkien kahvat yhteen, kunnes vetoniitti lukittuu.

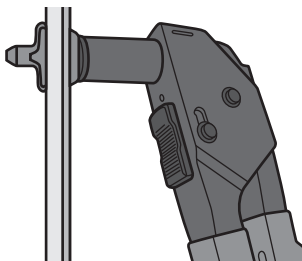

3. Murra niitin varsi tai leikkaa se leikkurilla.

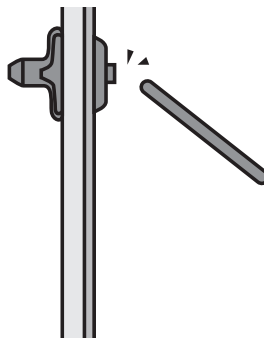

Käyttöesimerkkejä

Auton irrallisen sisälokasuojan korjaaminen

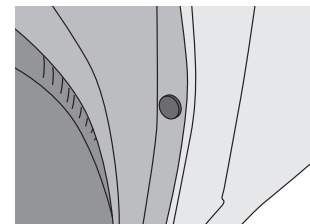
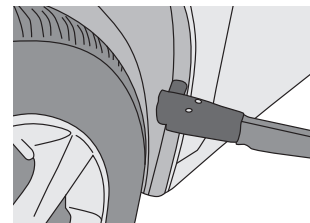

Kierrättäminen

Kierrätä tuote asianmukaisesti, kun poistat sen käytöstä. Tarkempia kierrätysohjeita saat kuntasi jäteneuvonnasta.

Tekniset tiedot

Pakkauksessa olevat vetoniitit:
 10 kpl 5 × 15,8 mm
 10 kpl 5 × 17,2 mm
 10 kpl 6,6 × 17,2 mm
 10 kpl 6,3 × 25,2 mm

Blindnieten-Satz

Art.Nr. 40-8706

Vor Inbetriebnahme die komplette Bedienungsanleitung durchlesen und aufbewahren. Irrtümer, Abweichungen und Änderungen behalten wir uns vor. Bei technischen Problemen oder anderen Fragen freut sich unser Kundenservice über eine Kontaktaufnahme.

Betrieb

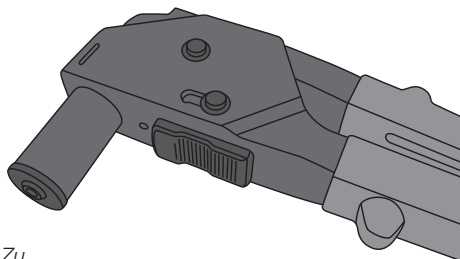

Zu

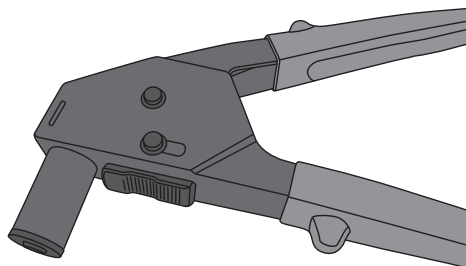

Offen

1. Die Blindniete erst in die Zange und dann in das Loch setzen.

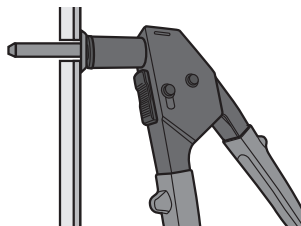

2. Den Griff der Zange zusammendrücken bis die Blindniete fest sitzt.

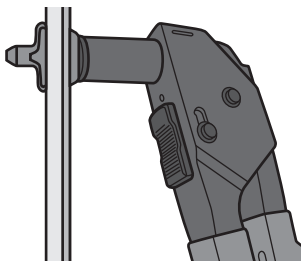

3. Den Dorn abbrechen oder mit einem Seitenschneider entfernen.

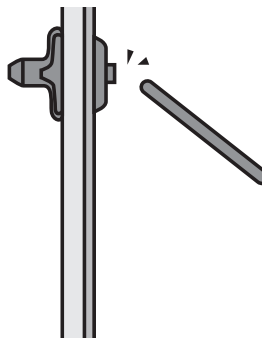

Verwendungsbeispiel

Reparieren einer losen PKW-Radhausschale

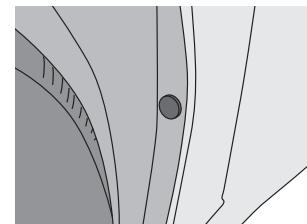
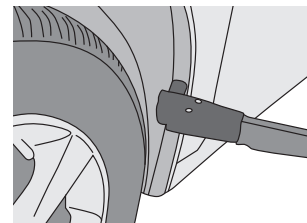

Hinweise zur Entsorgung

Bitte das Produkt entsprechend den lokalen Bestimmungen entsorgen. Weitere Informationen sind von der Gemeinde oder den kommunalen Entsorgungsbetrieben erhältlich.

Technische Daten

Anzahl mitgelieferte Blindnieten:

10 St. 5 × 15,8 mm

10 St. 5 × 17,2 mm

10 St. 6,6 × 17,2 mm

10 St. 6,3 × 25,2 mm